

# Dachaufsicht : r Bestandsaufnahme MehrG erationenhaus

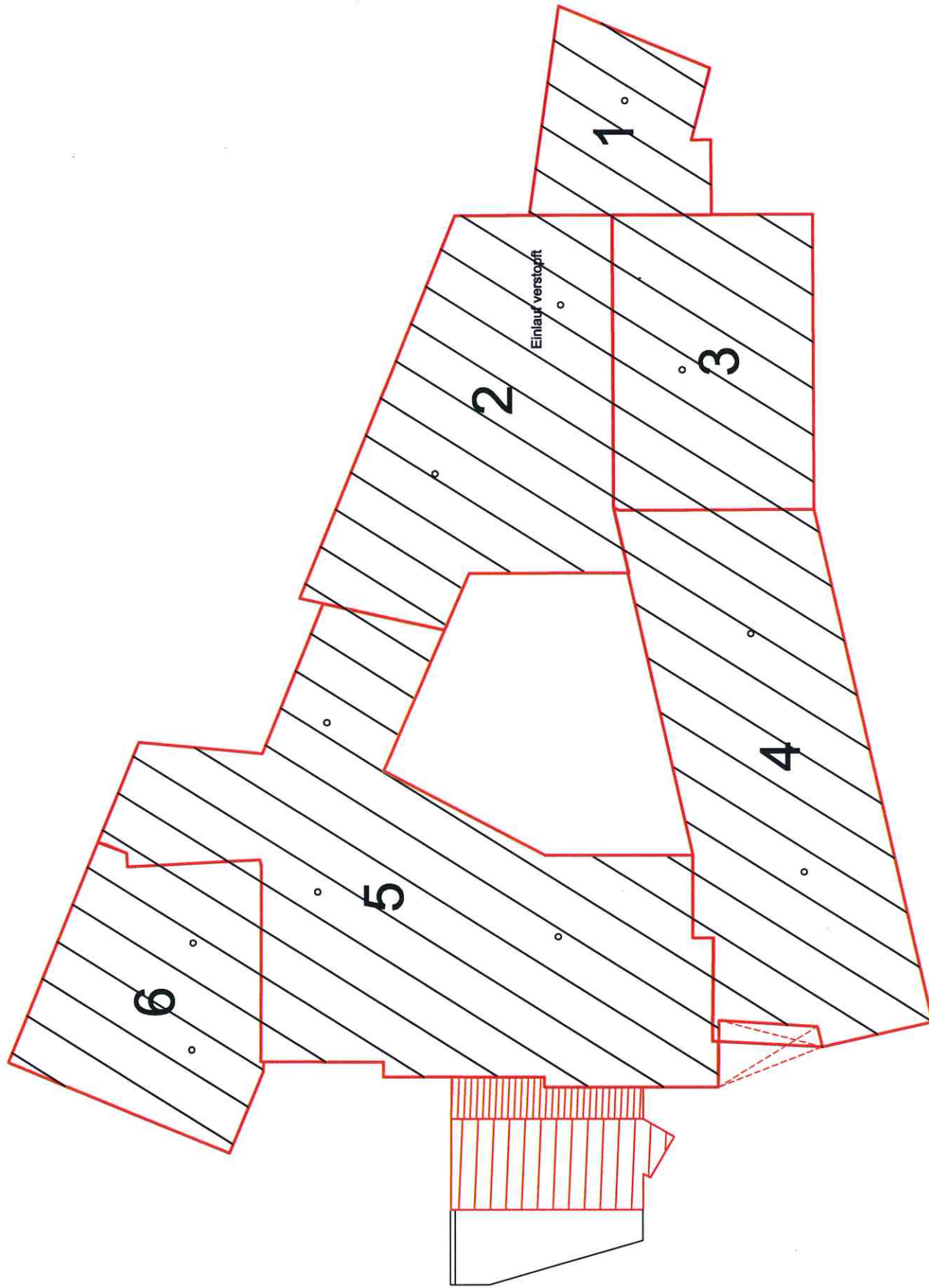

## Dachflächen:

- |   |   |
|---|---|
| 1 | A= 75.35 m <sup>2</sup><br>U= 36.74 m   |
| 2 | A= 229.60 m <sup>2</sup><br>U= 65.81 m  |
| 3 | A= 151.60 m <sup>2</sup><br>U= 50.08 m  |
| 4 | A= 277.30 m <sup>2</sup><br>U= 76.70 m  |
| 5 | A= 390.40 m <sup>2</sup><br>U= 107.27 m |
| 6 | A= 139.30 m <sup>2</sup><br>U= 48.37 m  |